



[northerntrustopen.com](http://northerntrustopen.com)

# NORTHERN TRUST OPEN PRO-AM



Mark Wahlberg; Don Cheadle and Phil Mickelson; Dennis Hasbert; Marshall Faulk and Mike Weir.

*The course is beautiful, the holes are tournament-ready, and pros from around the world are primed to compete in the 2010 Northern Trust Open.*

As a corporate partner of the Northern Trust Open, you can offer your special clients a one-of-a-kind experience to live out their golf fantasy by teaming up with one of the world's top TOUR professionals. Pro-Am participants get a unique glimpse of what it is like to be on the TOUR for a day while competing inside the ropes at Riviera – one of the TOUR's most revered courses. You simply can't get closer to the action.

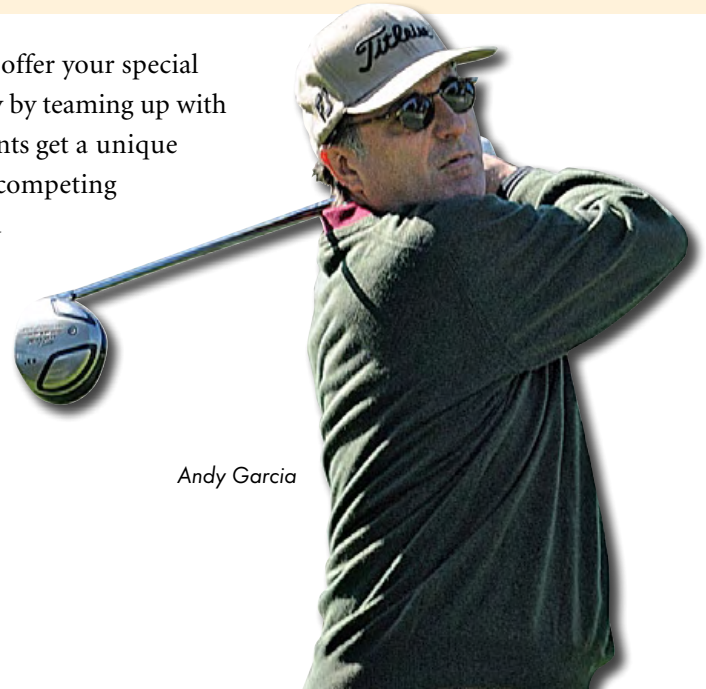

Andy Garcia



# NORTHERN TRUST OPEN PRO-AM SCHEDULE



## **Kick-Off Pro-Am:**

Monday, February 1 – 8:00 AM start

Each Kick-Off Pro-Am contestant receives:

- Pairing with a PGA TOUR professional competing in the Northern Trust Open
- Special Pro-Am gift package
- Commemorative Player's Money Clip
- Two weekly Clubhouse Badges providing admission to Riviera Country Club for the entire week of the Northern Trust Open
- Continental breakfast, lunch and awards reception

## **Official Northern Trust Open Pro-Am:**

Wednesday, February 3 – 6:40 AM or 11:00 AM starts

Each Official Pro-Am contestant receives:

- Pairing with a top-ranked PGA TOUR professional competing in the Northern Trust Open
- Unique, three-player plus PGA TOUR professional format
- Special Rodeo Drive gift package experience
- Commemorative Player's Money Clip
- Two weekly Clubhouse Badges providing admission to Riviera Country Club for the entire week of the Northern Trust Open
- One VIP Parking Pass
- Continental breakfast, lunch and awards reception



To learn more, call 310.407.0238 or email [matt@northerntrustopen.com](mailto:matt@northerntrustopen.com)

# SUNSET CLUB

on the 17<sup>TH</sup> Fairway



The Sunset Club on the 17<sup>TH</sup> fairway offers views of both the famous par-3, 4<sup>TH</sup> hole and the legendary 17<sup>TH</sup>. Flatscreen televisions and in-suite, real-time scoring kiosks allow your guests to track action throughout the course.

### Sunset Club Packages offer:

- Admission for 15 guests per day to the Sunset Club  
*four of the admission passes also include Clubhouse Access*
- Full food and beverage service included
- Eight VIP parking passes
- Corporate recognition board



# SUNSET CLUB

*on the 17<sup>TH</sup> Fairway*



## Sunset Club

Large climate-controlled venue includes:

- Open seating
- Large bar and buffet
- Upgraded food and beverage
- Patio seating overlooking the 4<sup>TH</sup> and 17<sup>TH</sup> holes

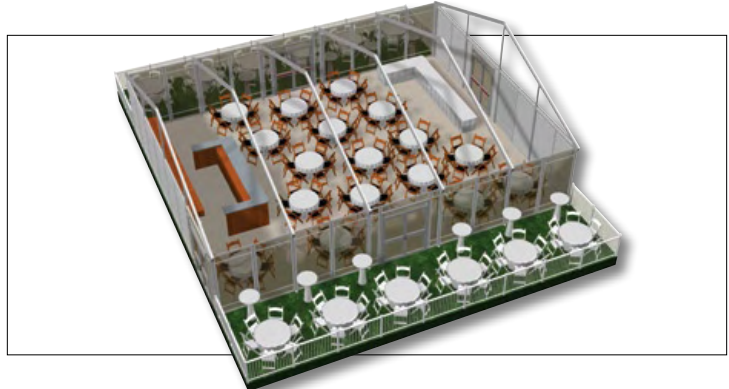

To learn more, call 310.407.0238 or email [matt@northerntrustopen.com](mailto:matt@northerntrustopen.com)

# PACIFIC SUITES

*on the 14<sup>TH</sup> Hole*



Catch all the drama on the picturesque 14<sup>TH</sup> hole with tee-to-green views from the Pacific Suites. Nestled in the center of Riviera, this par-3, 176-yard hole isn't the longest on the course but the split-level green and the visually deceptive layout make it one of Riviera's most challenging. Flatscreen televisions and in-suite, real-time scoring kiosks allow your guests to track action throughout the course.

## Your private Pacific Suite provides:

- Admission for 25 guests per day into your Pacific Suite
- Full food and beverage service included
- 13 VIP parking passes
- One Wednesday Official Pro-Am threesome
- One Monday Kick-off Pro-Am foursome
- Additional 50 grounds tickets (good any day)
- 25 merchandise vouchers, good any day, with a value of \$25 each
- Spectator Guide/Program acknowledgment



# PACIFIC SUITES

*on the 14TH Hole*



## Pacific Suites

Climate-controlled venue includes:

- 60" dining table with linen and floral arrangement
- Table seating for 10
- Tiered seating for 12
- Shared bar & buffet tables with floral arrangements

Additional covered seating is available and includes:

- Tiered seating for eight

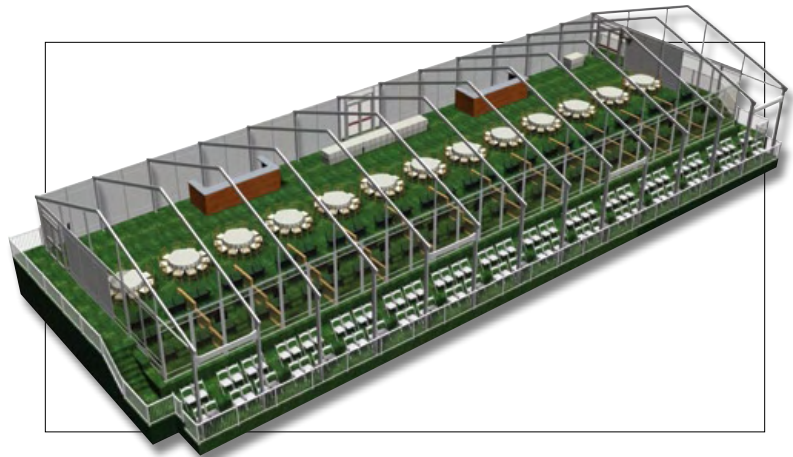

To learn more, call 310.407.0238 or email [matt@northerntrustopen.com](mailto:matt@northerntrustopen.com)

# CANYON MARQUEE SUITES

on the 17<sup>TH</sup> Green



Riviera's par-5, 17<sup>TH</sup> is one of the Northern Trust Open's pivotal holes—almost always playing a key role in determining the championship. It is a monumental 590 yards but length isn't its only characteristic. The 17<sup>TH</sup> requires balancing muscle and finesse, featuring a severely sloped two-tier green that challenges contenders to the end. The Canyon Marquee Suites provide you unobstructed views overlooking the 17<sup>TH</sup> hole. Flatscreen televisions and in-suite, real-time scoring kiosks allow your guests to track action throughout the course.

## Your private Canyon Marquee Suite provides:

- Admission for 50 guests per day into your private suite, *includes Clubhouse access*
- 25 VIP parking passes
- One Wednesday official Pro-Am threesome
- One Monday Kick-off Pro-Am foursome
- Additional 200 grounds tickets (good any day)
- 50 merchandise vouchers, good any day, with a value of \$50 each
- Hole signage
- Sponsor board placement
- Spectator Guide/Program acknowledgment



# CANYON MARQUEE SUITES

on the 17<sup>TH</sup> Green

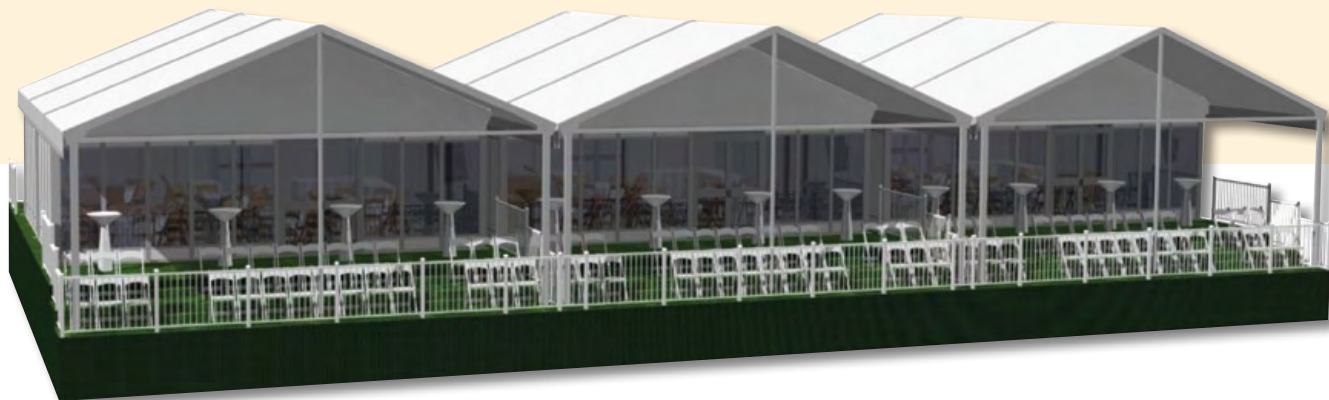

## Canyon Marquee Suites

33x33 climate-controlled venue includes:

- Five 60" dining tables with linens and floral arrangements
- 10 chairs per table for a total of 50 seats
- Bar & buffet tables with floral arrangements
- Reception table

Exterior covered seating includes:

- Tiered seating for 24
- Four standup cocktail tables

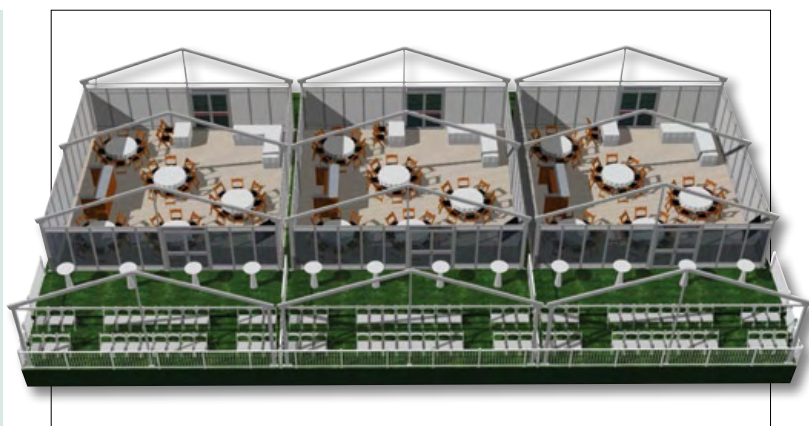

To learn more, call 310.407.0238 or email [matt@northerntrustopen.com](mailto:matt@northerntrustopen.com)

# ANCHOR CLUB SUITES

at the 18<sup>TH</sup> Green



Offering dramatic panoramic views of one of golf's most recognizable and challenging finishing holes, your private Anchor Club Suite offers a unique hospitality setting for you and your guests. Perched above the 18<sup>TH</sup> green, your guests will enjoy spectacular views of the famed course and one of golf's most unique signature holes, a hole Jack Nicklaus calls his favorite at Riviera. Flatscreen televisions and in-suite, real-time scoring kiosks allow your guests to track action throughout the course.

## Your private Anchor Club Suite provides:

- Admission for 50 guests per day to your private suite, includes Clubhouse access
- 25 VIP parking passes
- Two Wednesday Official Pro-Am threesomes
- Two Monday Kick-off Pro-Am foursomes
- Access to the Anchor Club Oasis – on-course hospitality with full food and beverage service
- Additional 200 grounds tickets (good any day)
- 50 merchandise vouchers, good any day, with a value of \$75 each
- Hole signage
- Entry signage
- Sponsor board placement
- Spectator Guide/Program acknowledgment
- Video board recognition



# ANCHOR CLUB SUITES

at the 18<sup>TH</sup> Green

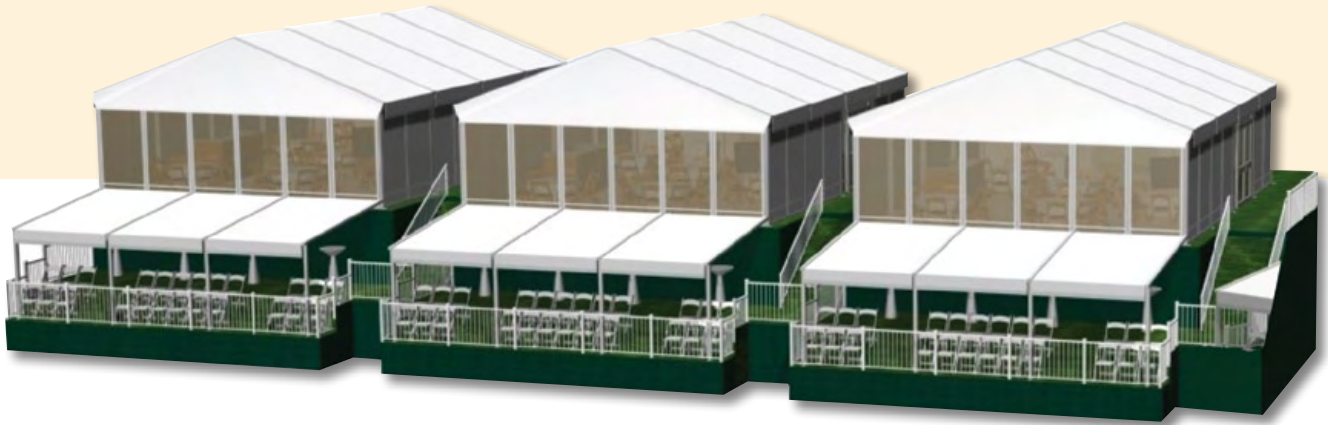

## Anchor Club Suites

30x40 climate-controlled venue includes:

- Five 60" dining tables with linens and floral arrangements
- 10 chairs per table for a total of 50 seats
- Bar & buffet tables with floral arrangements
- Reception table

Exterior covered seating includes:

- Tiered seating for 24
- Four standup cocktail tables

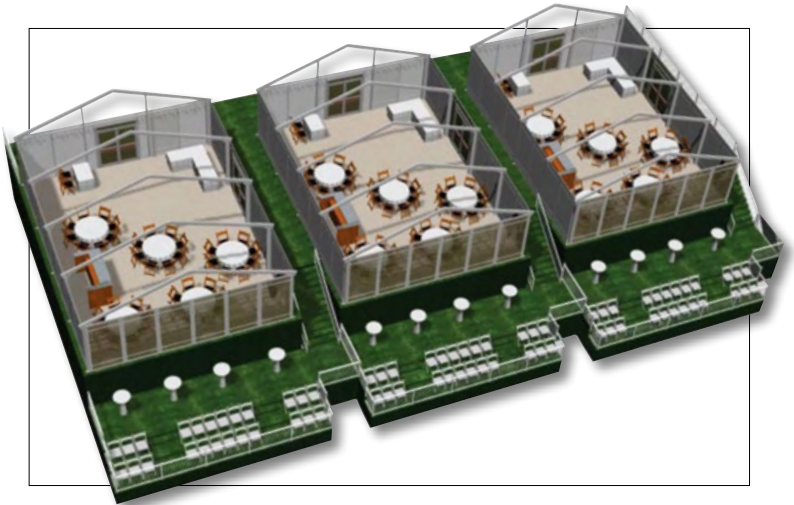

To learn more, call 310.407.0238 or email [matt@northerntrustopen.com](mailto:matt@northerntrustopen.com)